

**NOTE:**

8' TALL WALLS FRAMED WITH 2 X 4 STUDS @ 16" O.C.  
 8' TALL WALLS FRAMED WITH 2 X 6 STUDS @ 16" O.C.  
 10' AND TALLER WALLS SEE ENGINEERING.

DIMENSIONS ON FLOOR PLANS ARE TO ROUGH  
 FRAMING UNLESS OTHERWISE NOTED.

2 X 4 STUD WALLS ASSUMED TO BE 3 1/2" WIDE.

2 X 6 STUD WALLS ASSUMED TO BE 5 1/2" WIDE.

GAS LINE INFORMATION	
TYPE OF UNIT	TYPICAL BTU'S
FURNACE	125,000
WATER HEATER	40,000
FIREPLACE	30,000
RANGE	35,000
DRYER	35,000
BAR-B-QUE	15,000

GAS LINE SHALL BE 1" MAIN TO FURN AND THEN 1/2" LINE IF 1 OTHER GAS APPLIANCE IS USED; 3/4" LINE IF 2 OR MORE APPLIANCES ARE USED. BTU'S SHALL BE FACTORY SET PER LOCAL GAS REQ. (LONGEST DISTANCE TO APPLIANCE = 52') TOTAL BTU'S ALL APPLIANCES= 310,000 MT. FUEL BEST PRACTICE TABLE IV- USE 1 1/4" MAIN

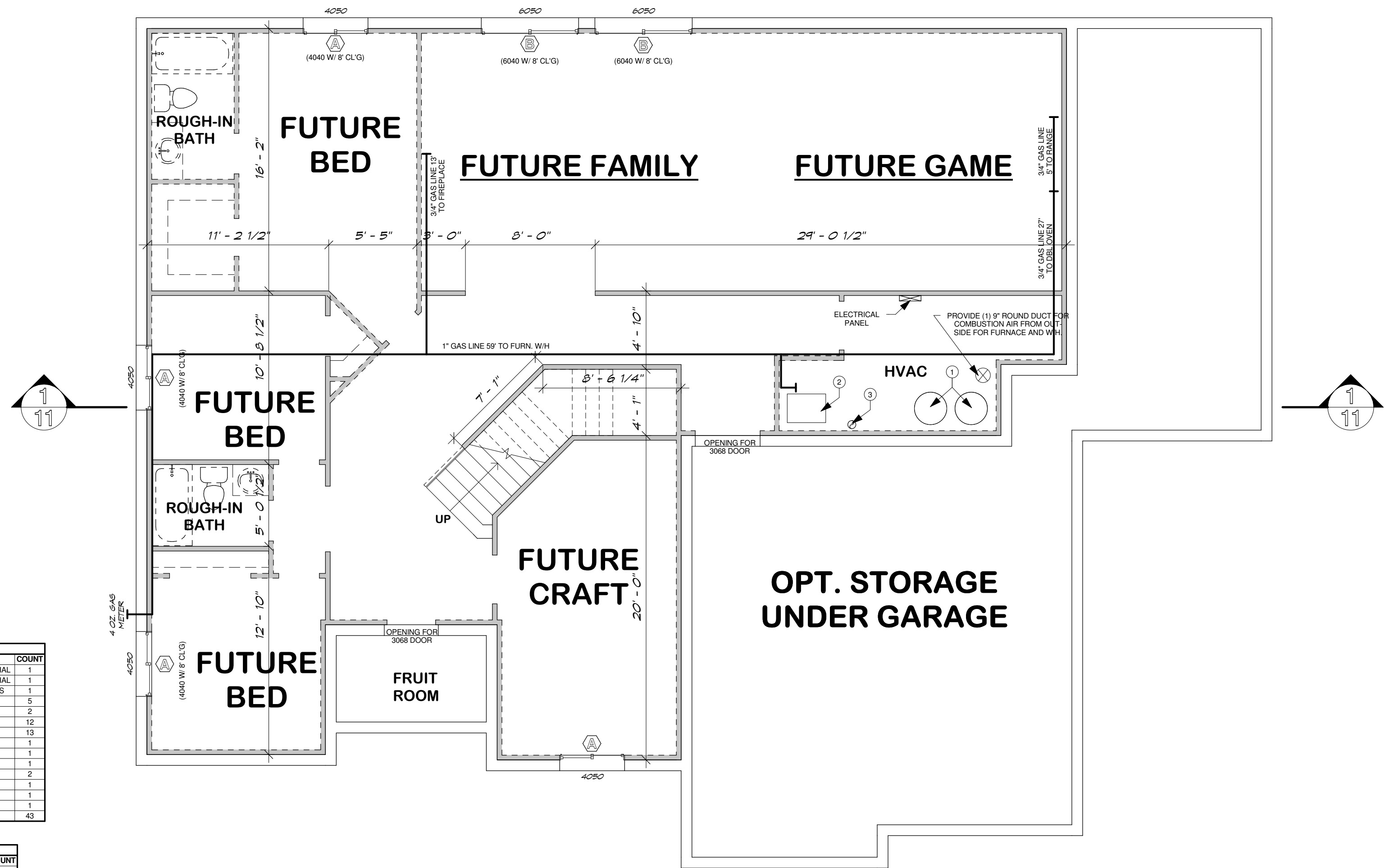

Door Schedule									
NUMBER	WIDTH	HEIGHT	MATERIAL	THICKNESS	JAMB	HARDWARE	DESCRIPTION	COUNT	
01	3'-0"	8'-0"	WOOD	0'-2"	FIR	LOCK & DEAD BOLT	INSULATED COLONIAL	1	
02	3'-0"	6'-8"	WOOD	0'-1 1/2"	FIR	LOCK & DEAD BOLT	INSULATED COLONIAL	1	
03	5'-0"	6'-8"	WOOD	0'-2"	FIR	LOCK	INSULATED GLASS	1	
04	3'-0"	6'-8"	WOOD	0'-1 1/2"	FIR	KNOB	COLONIAL	5	
05	2'-8"	6'-8"	WOOD	0'-1 1/2"	FIR	KNOB	COLONIAL	2	
06	2'-6"	6'-8"	WOOD	0'-1 1/2"	FIR	KNOB	COLONIAL	12	
07	2'-4"	6'-8"	WOOD	0'-1 1/2"	FIR	KNOB	COLONIAL	13	
08	2'-0"	6'-8"	WOOD	0'-1 1/2"	FIR	KNOB	COLONIAL	1	
09	1'-8"	6'-8"	WOOD	0'-1 1/2"	FIR	KNOB	COLONIAL	5	
10	5'-0"	6'-8"	WOOD	0'-1 1/2"	FIR	KNOB	DOUBLE PANEL	1	
11	4'-0"	6'-8"	WOOD	0'-1 1/2"	FIR	KNOB	DOUBLE PANEL	2	
12	3'-0"	6'-8"	WOOD	0'-2"	FIR	KNOB	COLONIAL	1	
13	9'-0"	8'-0"	METAL	0'-2"		LOCK		1	
14	18'-0"	8'-0"	METAL	0'-2"		LOCK		1	
Grand total								43	

Window Schedule							
NUMBER	WIDTH	HEIGHT	TYPE	FRAME	GLAZING	DESCRIPTION	COUNT
A	4'-0"	5'-0"	SLIDER	VINYL	THERMAL BREAK	INSULATED, WHITE, CLEAR	4
B	6'-0"	5'-0"	SLIDER	VINYL	THERMAL BREAK	INSULATED, WHITE, CLEAR	2
C	5'-0"	6'-0"	SLIDER	VINYL	THERMAL BREAK	INSULATED, WHITE, CLEAR	5
D	5'-0"	2'-0"	ARCH	VINYL	THERMAL BREAK	INSULATED, WHITE, CLEAR	3
E	1'-0"	8'-0"	FIXED	VINYL	THERMAL BREAK	INSULATED, WHITE, CLEAR	2
F	5'-0"	4'-0"	SLIDER	VINYL	THERMAL BREAK	INSULATED, WHITE, CLEAR	1
G	3'-0"	6'-0"	FIXED	VINYL	THERMAL BREAK	INSULATED, WHITE, CLEAR	4
H	6'-0"	6'-0"	SLIDER	VINYL	THERMAL BREAK	INSULATED, WHITE, CLEAR	1
I	5'-0"	5'-0"	SLIDER	VINYL	THERMAL BREAK	INSULATED, WHITE, CLEAR	1
J	4'-0"	4'-0"	SLIDER	VINYL	THERMAL BREAK	INSULATED, WHITE, CLEAR	1
K	4'-0"	5'-0"	SLIDER	VINYL	THERMAL BREAK	INSULATED, WHITE, CLEAR	1
L	3'-0"	3'-0"	FIXED	VINYL	THERMAL BREAK	INSULATED, WHITE, CLEAR	2
M	5'-0"	4'-6"	ARCH	VINYL	THERMAL BREAK	INSULATED, WHITE, CLEAR	1
N	3'-0"	2'-0"	FIXED	VINYL	THERMAL BREAK	INSULATED, WHITE, CLEAR	2
O	5'-0"	2'-0"	FIXED	VINYL	THERMAL BREAK	INSULATED, WHITE, CLEAR	1
P	3'-0"	5'-0"	S.H.	VINYL	THERMAL BREAK	INSULATED, WHITE, CLEAR	2
Q	4'-0"	1'-0"	SLIDER	VINYL	THERMAL BREAK	INSULATED, WHITE, CLEAR	1
R	2'-0"	3'-0"	FIXED	VINYL	THERMAL BREAK	INSULATED, WHITE, CLEAR	1
S	5'-10"	5'-0"	ARCH	VINYL	THERMAL BREAK	INSULATED, WHITE, CLEAR	1
Grand total							36



**Walker Home Design**

4586 S. BOWERS VISTA CIR. (625 E.)  
 SALT LAKE CITY, UT 84107  
 (801)263-2787 office (801)699-7262 cell

www.walkerhomedesign.com

**KEYNOTES**

- (1) 50 GALLON GAS WATER HEATER W/OPT. 2ND WATER HEATER W/ EXPANSION TANK. 40,000 BTU'S (WITH SEISMIC HOLDDOWNS) (WITH ONE WAY CHECK HEAT VALVES) (1/2" FOAM INS. AT HOT WATER LINES)
- (1)80% EFFICIENCY CLASS FURNACES 100,000 BTU'S (i.e. TEMPSTAR NUG5100 DFA)
- FLUE

Copyright © Walker Home Design INC. All rights reserved. The use of these plans is expressly limited to Walker Home Design INC. and those who have purchased plans with a letter of usage. Reproduction, re-use, or publication by any method, in whole or in part, is prohibited.

**BRECKENRIDGE**

Designed for  
**WRIGHT CUSTOM HOMES**

Plan # 3126

Date FEB. 2006

Drawn by WHD

PRINTED: 3/16/2006 5:32:01 PM  
 Sheet 3 of 22  
 OPT. STORAGE: 569  
 FRUIT ROOM: 49  
 UPPER LEVEL: 1,020  
 LOWER LEVEL: 1,970  
 MAIN LEVEL: 2,106  
 TOTAL: 5,714

**LOWER LEVEL FLOOR PLAN**

Scale: 3/16" = 1' - 0"